















Enedhwaith

0 5 10 20



Dunfearan

Gillien

Gilsen

Chorl Caendh

Mjeshedass

Angwenose

Nan Cukunin

Taur Fangorn

Wold Lomen

Eregion

Sramon

Moria

Celebdil

Cirich Canadhnas

Canadhnas

Fenudhol

Nanduhimen

Nimrodol

Lórien

E Naith

Canin Amneth

Canas Galadhen

Parth Celebrant

Wold

Nan Anduin



0 5 10 16 km

Sin Ninglon

Brúinen

En Eglacht

En Credonriach

Mieherchel

Tennas Drúnnin

Glanduin

Nin-in-Gilph

Lewach Dainnan



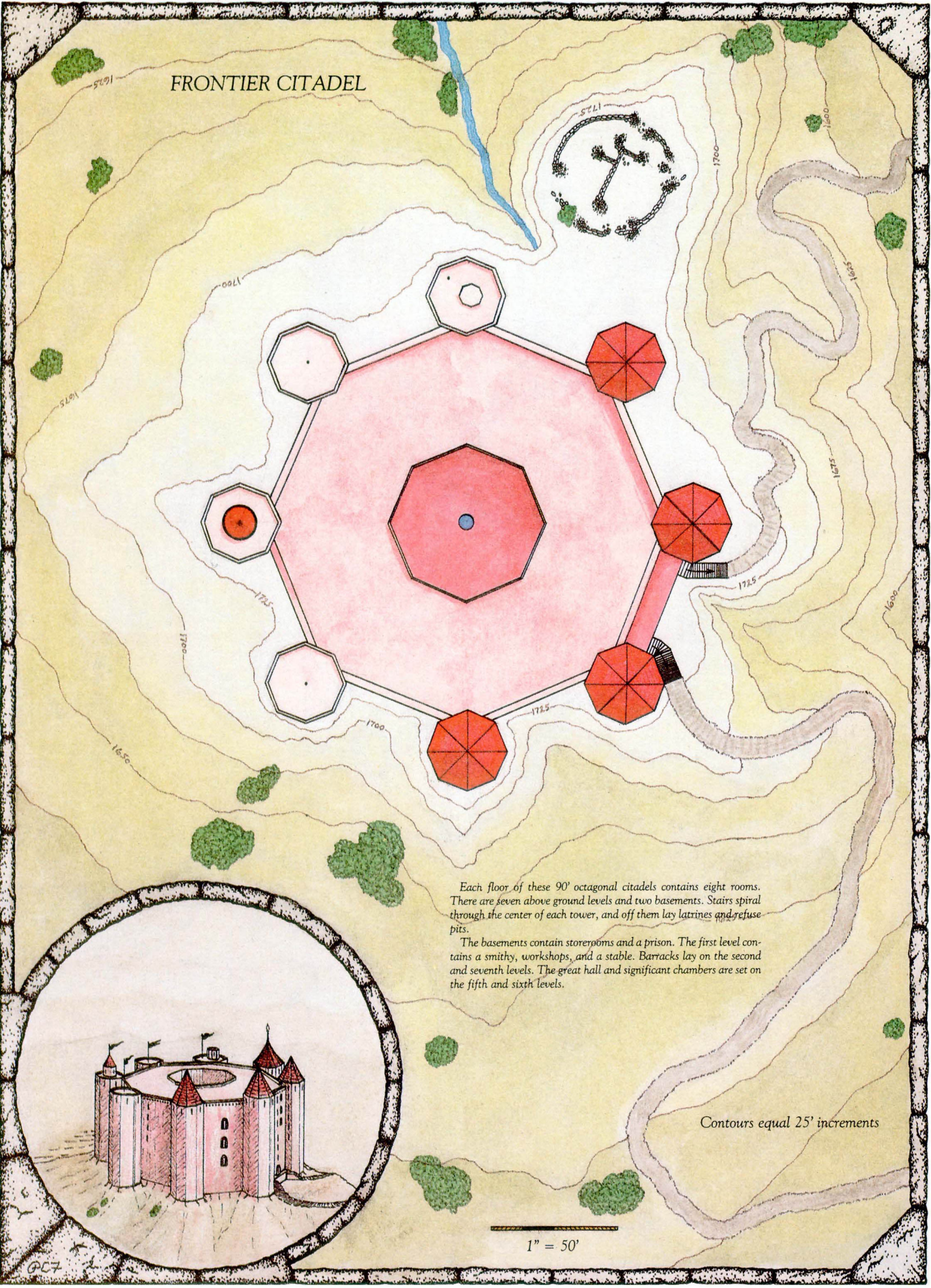
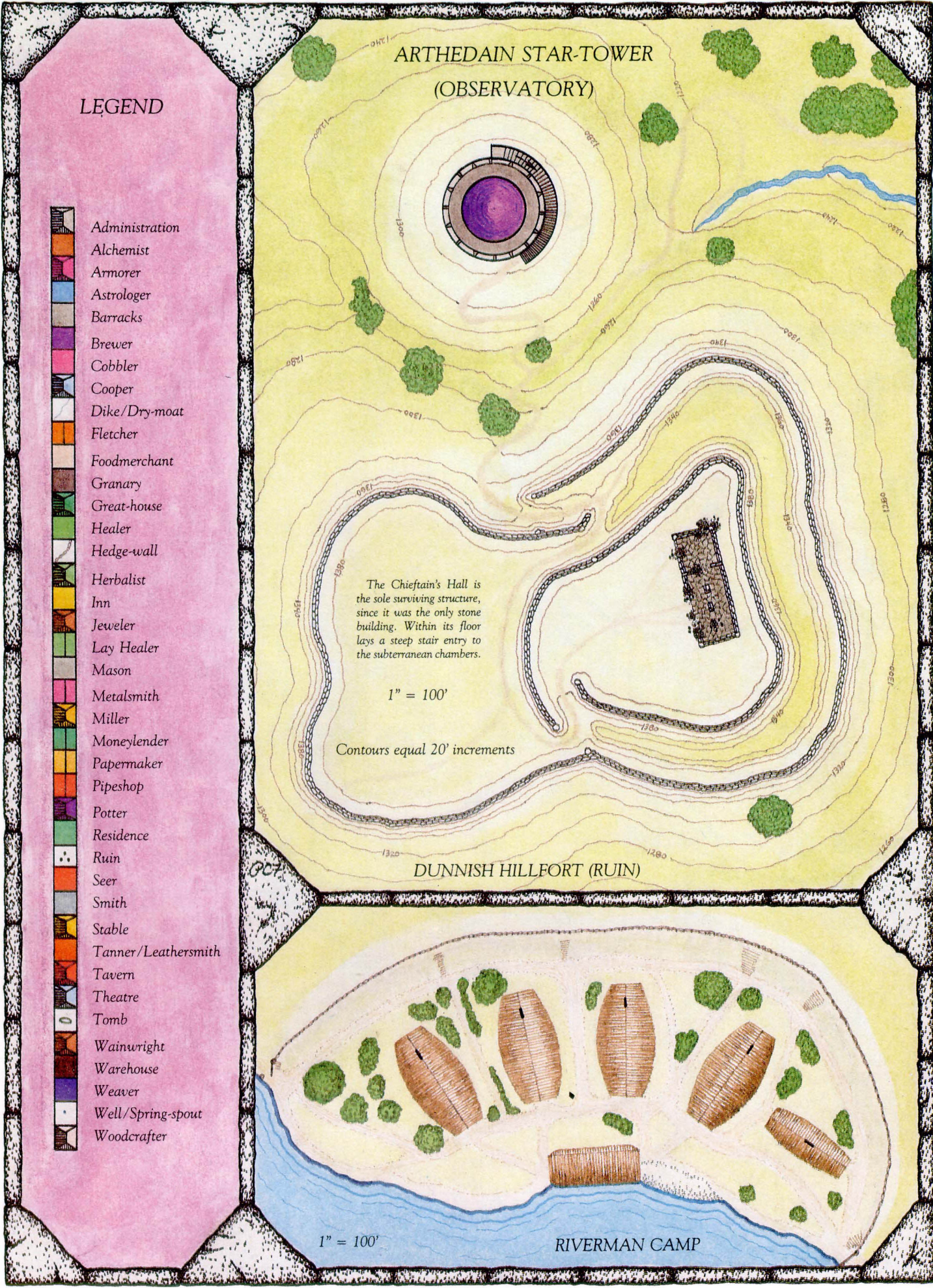
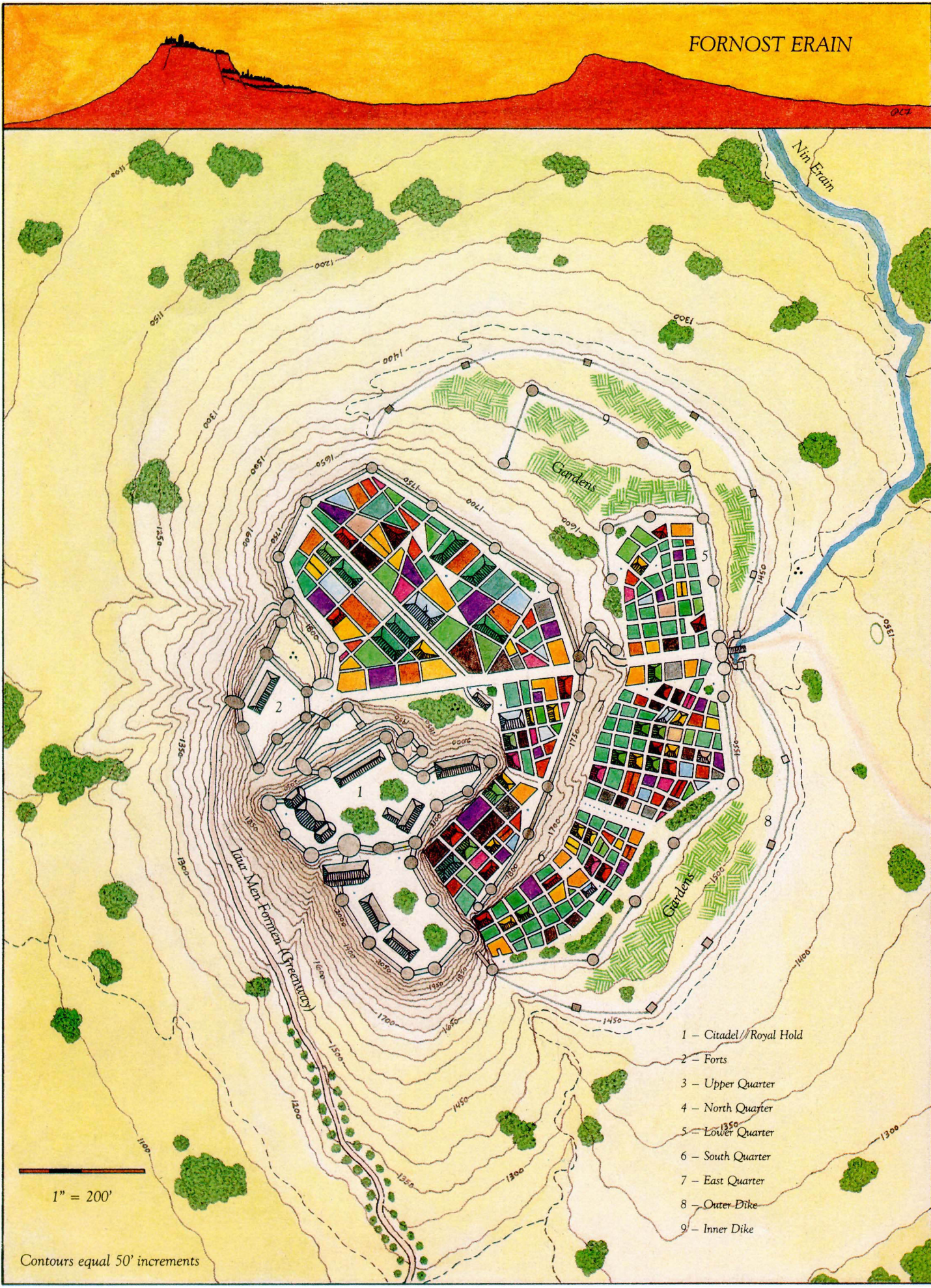
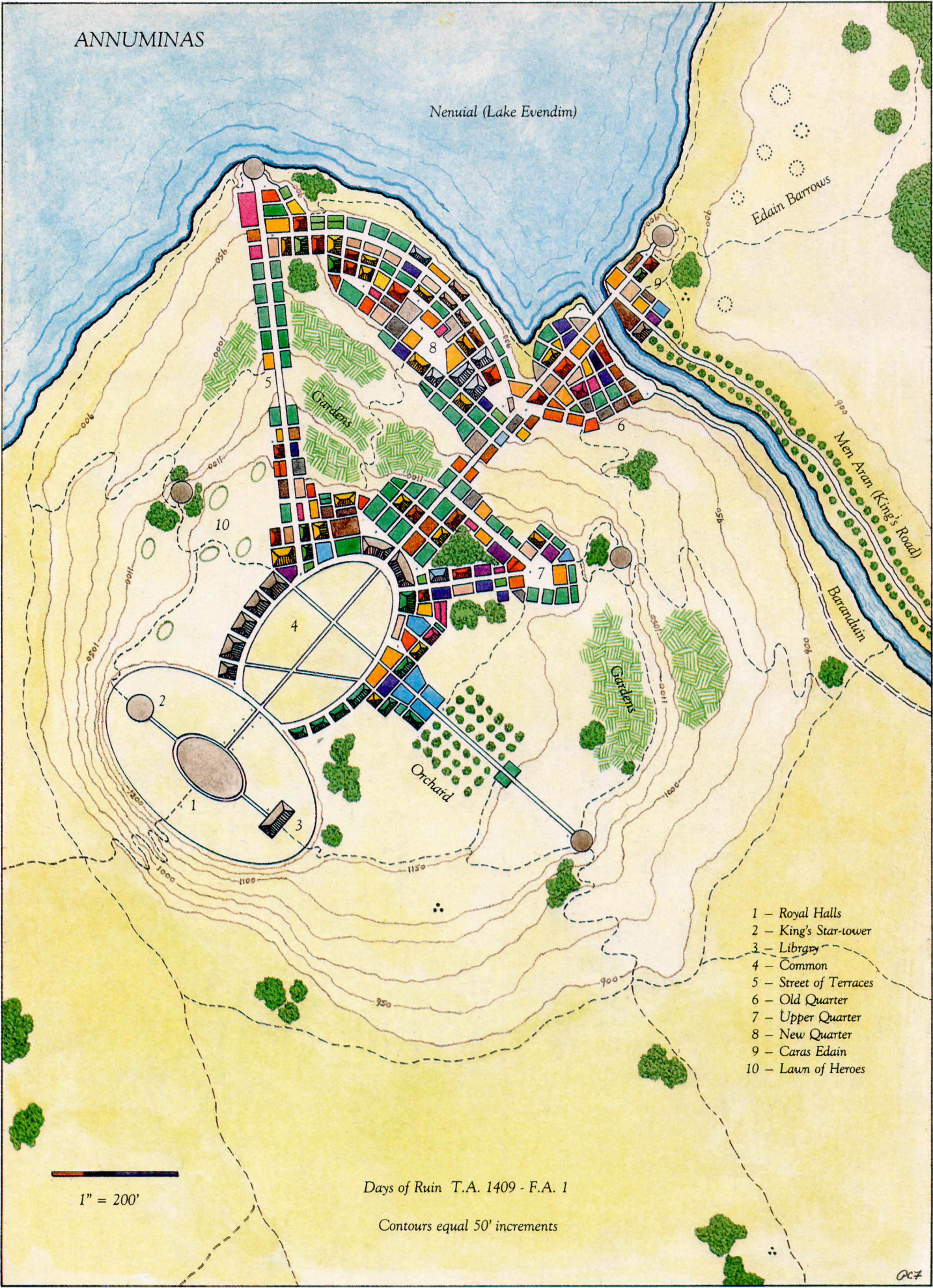



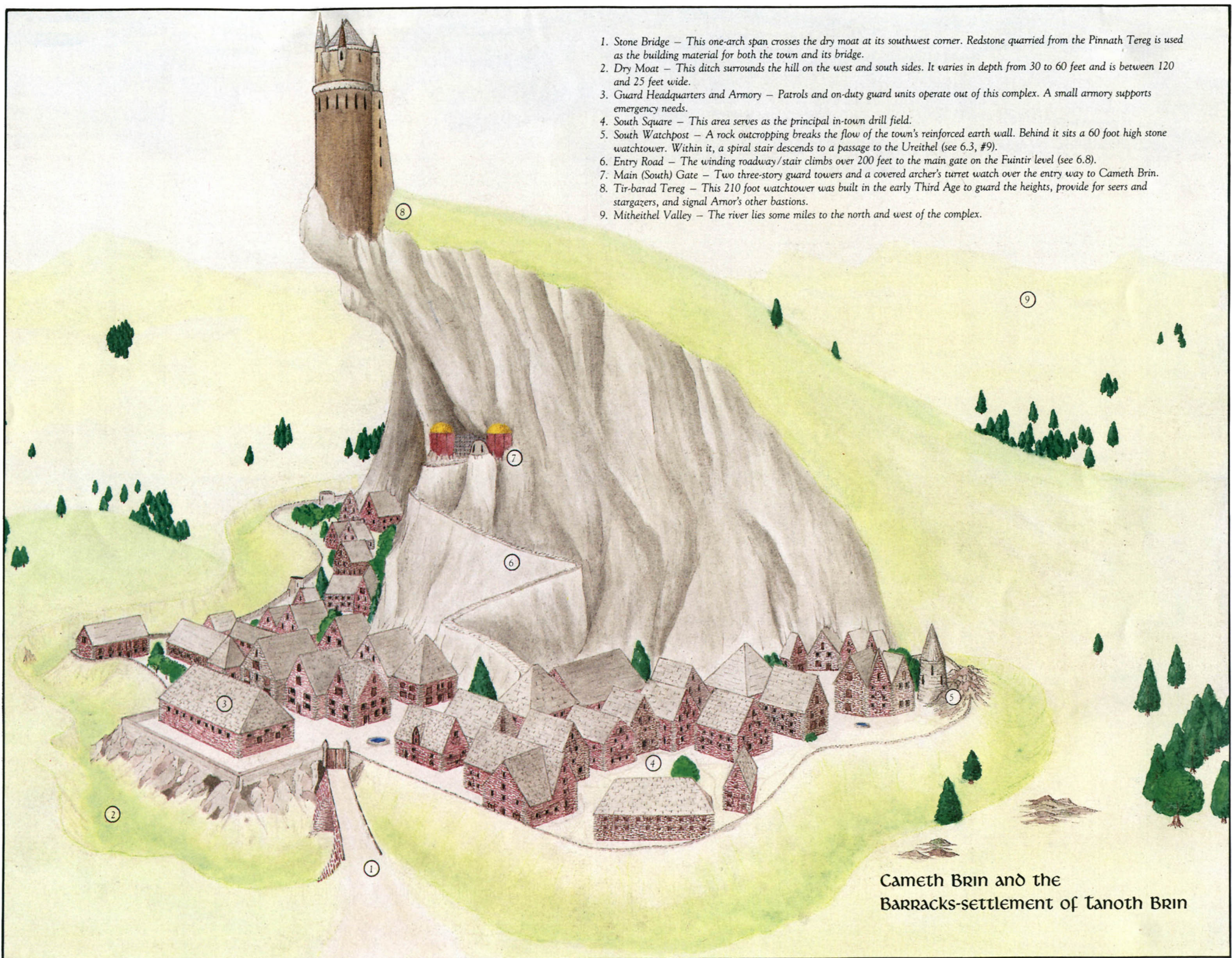
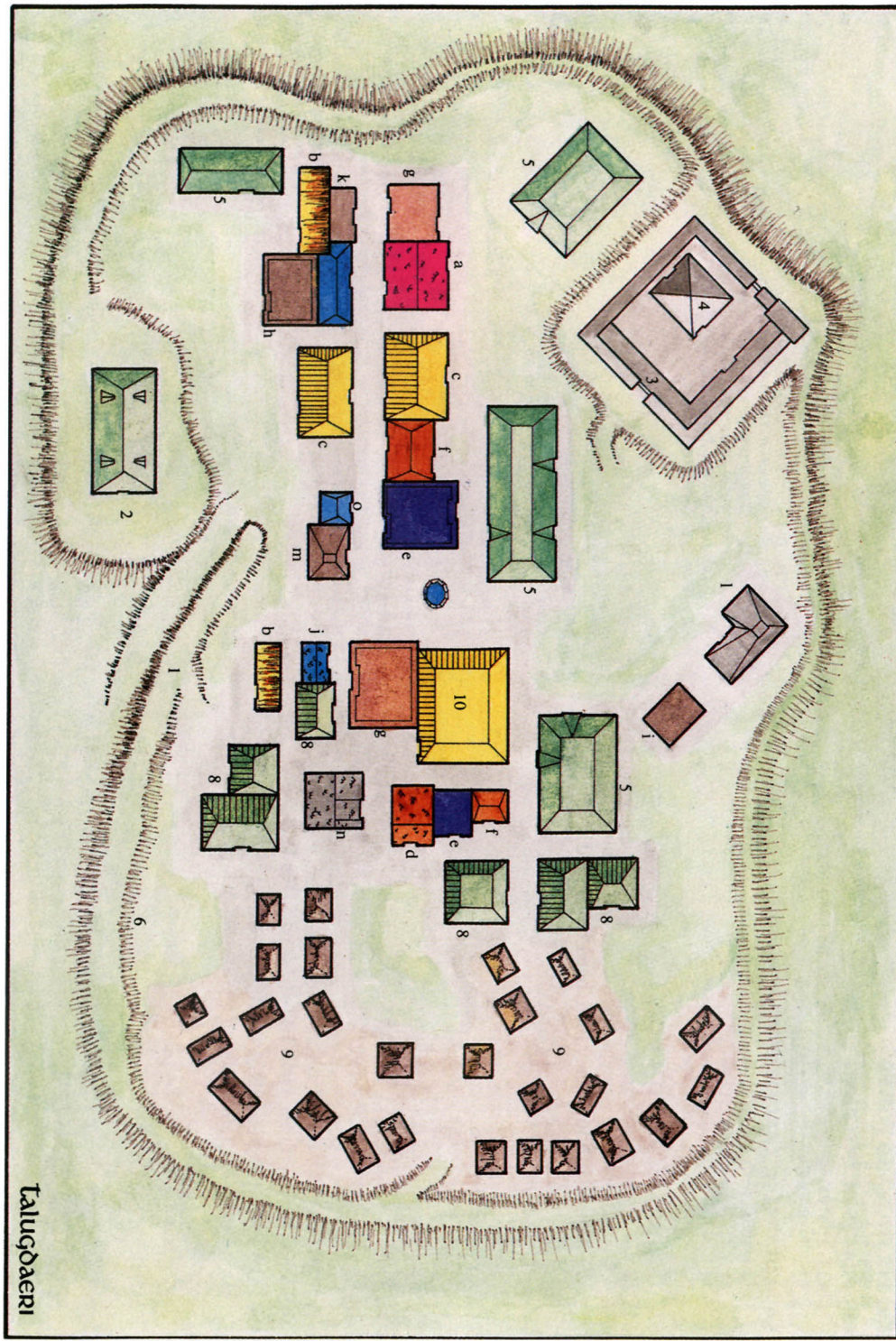

1. Stone Bridge – This one-arch span crosses the dry moat at its southwest corner. Redstone quarried from the Pinnath Tereg is used as the building material for both the town and its bridge.
2. Dry Moat – This ditch surrounds the hill on the west and south sides. It varies in depth from 30 to 60 feet and is between 120 and 25 feet wide.
3. Guard Headquarters and Armory – Patrols and on-duty guard units operate out of this complex. A small armory supports emergency needs.
4. South Square – This area serves as the principal in-town drill field.
5. South Watchpost – A rock outcropping breaks the flow of the town's reinforced earth wall. Behind it sits a 60 foot high stone watchtower. Within it, a spiral stair descends to a passage to the Ureithel (see 6.3, #9).
6. Entry Road – The winding roadway/stair climbs over 200 feet to the main gate on the Fuintir level (see 6.8).
7. Main (South) Gate – Two three-story guard towers and a covered archer's turret watch over the entry way to Cameth Brin.
8. Tir-barad Tereg – This 210 foot watchtower was built in the early Third Age to guard the heights, provide for seers and stargazers, and signal Amor's other bastions.
9. Mitheithel Valley – The river lies some miles to the north and west of the complex.

Cameth Brin and the Barracks-settlement of Tanoth Brin